

# FOR SALE



**5354 Thompson Mill Rd.  
At Friendship Rd, Hall County**



## Adjoins retail development on Spout Springs Rd

- 7 parcel assemblage; 14+/- acres!
- Main entrance : 5354 Thompson Mill Rd, Hoschton, GA 30548.
- All utilities available, currently Zoned AR4 and can be annexed into Braselton.
- Excellent location for Apartments, Medical, Office, Commercial, Retail or Residential!
- High traffic area; close to NE GA Medical; easy access to I-85.
- Asking price: \$280,000 per acre!

**Contact Doug for more info:**

**dgarrison@gonorton.com 678-858-2978**



"The above information is believed to be accurate but is not warranted. Information is subject to change without notice.  
Equal Housing Opportunity."

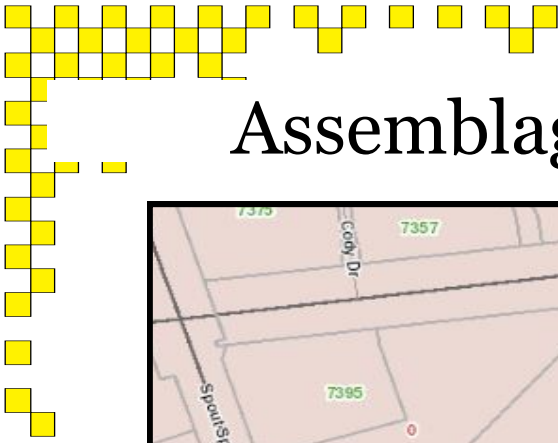

# Assemblage & Street Views

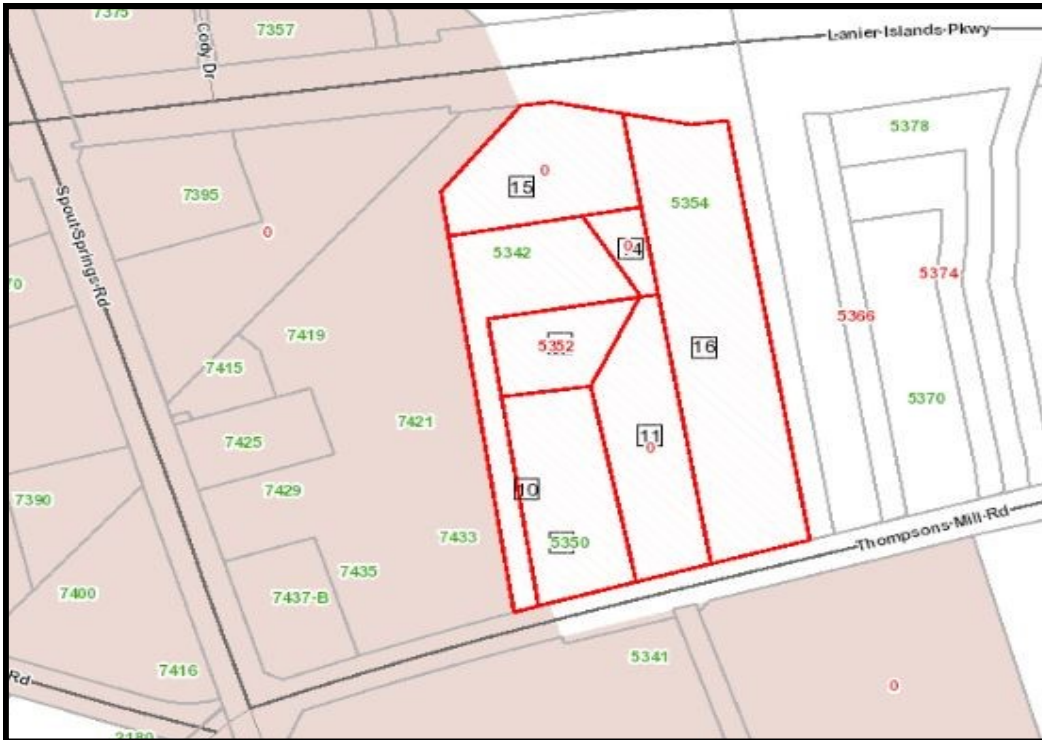

**Contact Doug for more info:**  
**dgarrison@gonorton.com 678-858-2978**



*"The above information is believed to be accurate but is not warranted. Information is subject to change without notice.  
Equal Housing Opportunity."*



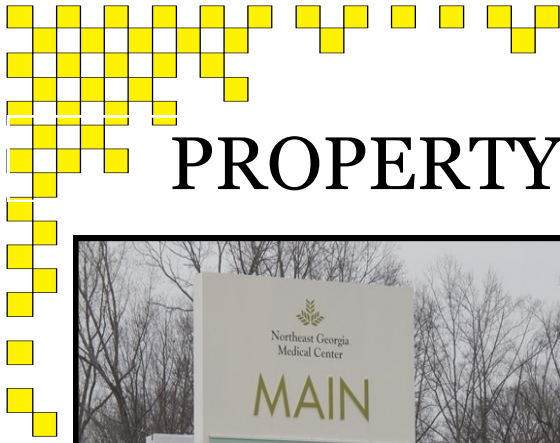

# PROPERTY AREA PHOTOS



High traffic area close to NE GA Medical; with easy access to I-85.



## Contact Doug for more info:

[dgarrison@gonorton.com](mailto:dgarrison@gonorton.com) 678-858-2978



*"The above information is believed to be accurate but is not warranted. Information is subject to change without notice. Equal Housing Opportunity."*